



PUNCHING



DRILLING



www.alfra.de



CUTTING



DEBURRING

# ALFRA-MAGNETIC-SYSTEMS

LIFTING-MOVING-POSITIONING-ALIGNING-FORMING-TRANSPORTING

NEW



05/2015





## TML 250

**TML250**

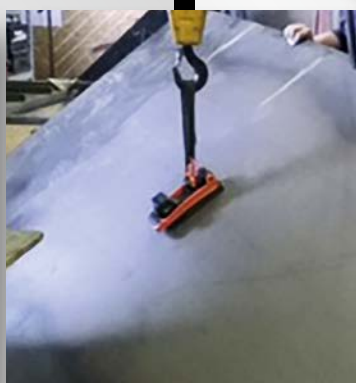

## TML 500

**TML500**



### Key Facts TML 250:

- Up to 250 kg Lifting Force at 10 mm material thickness and 90 kg lifting force already at 3 mm material thickness (The stated performance adds a safety-factor of 3 for the lifting operation. This means, that the tear-off force needs to be three times the maximal lifting force.)
- Outstanding performance on thin walled materials
- Weight reduction of 70% at same lifting force
- Effortless and ergonomic one-lever magnet activation
- Revolutionary magnetic technology allows for a much wider range of lifting solutions
- 360° rotating lifting hook
- TiN-coated, hardened steel magnetic adhesive surface

### Technical Data TML 250:

- Weight: 3,5 kg
- Up to 750 kg max. lifting force
- Max load: up to 250 kg (1:3 Safe working load)
- Length: 240 mm (closed lever), Width: 91 mm, Height: 191 mm (open lever)
- Magnetic contact surface: Length: 135 mm, Width: 65 mm

Prod.-No. 41250

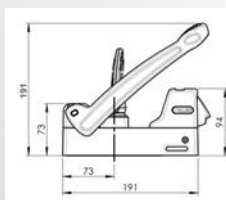
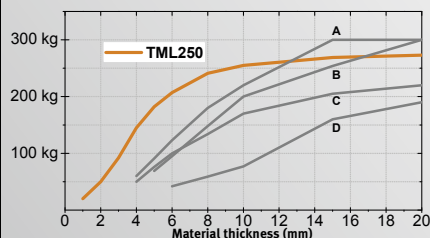

### Competitor A-D:

- A:** 300 kg Permanent Lifting Magnet; 9 kg Weight
- B:** 300 kg Permanent Lifting Magnet; 11 kg Weight
- C:** 250 kg Permanent Lifting Magnet; 10 kg Weight
- D:** 250 kg Permanent Lifting Magnet; 10 kg Weight



### Key Facts TML 500:

- 300 kg lifting force already at 5 mm material thickness and 490 kg lifting force at 10 mm material thickness and (The stated performance adds a safety-factor of 3 for the lifting operation. This means, that the tear-off force needs to be three times the maximal lifting force.)
- Outstanding performance on thin walled materials
- Weight reduction of 70% at same lifting force (than competitive magnets)
- Effortless and ergonomic one-lever magnet activation
- Revolutionary magnetic technology allows for a much wider range of lifting solutions
- 360° rotating lifting hook
- TiN-coated, hardened steel magnetic adhesive surface

### Technical Data TML 500:

- Weight: 7,3 kg
- Up to 1.500 kg max. lifting force
- Max load: up to 500 kg (1:3 Safe working load)
- Max. Vertical Lifting Capacity: 150 kg at 90 degrees (from 15 mm S235 with 1:3 Safe working load)
- Length: 295 mm (closed lever), Width: 118 mm, Height: 216 mm (open lever)
- Magnetic contact surface: Length: 185 mm, Width: 88 mm

Prod.-No. 41500

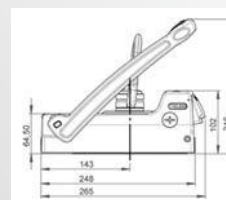
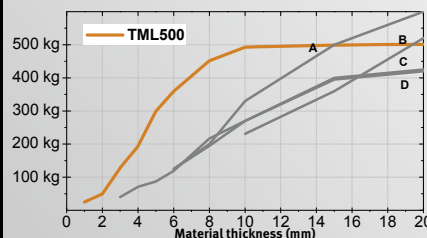

### Competitor A-D:

- A:** 600 kg Permanent Lifting Magnet; 22 kg Weight
- B:** 600 kg Permanent Lifting Magnet; 24 kg Weight
- C:** 500 kg Permanent Lifting Magnet; 20 kg Weight
- D:** 500 kg Elektromagnet; 8 kg Weight



**ONE SOLUTION FOR HUNDREDS OF APPLICATION POSSIBILITIES!**

**LIFTING-MOVING-POSITIONING-ALIGNING-FORMING-TRANSPORTING**



## TMC 300 - MAGNET BASE:



### Key Facts TMC 300 as Magnet Base:

- Up to 300 kg lifting force, even on a steel plate of only 6 mm thickness
- Ergonomic and easy one-hand actuation
- M5 and M6 tapped holes on the top as well as on the sides enable an easy attachment of handling accessories like cutting guides, angle side plates, handles and much more
- Ideal workload easement, f. e. for plate levelling, platform building, fixturing and workholding of all types
- The specially arrested magnet field (patented) allows welding with distance as close as 15 mm to the magnet-outside
- Hardened steel base with TIN coating for a long lifetime at simultaneously low airgap – avoids damages of the lower surface
- Incredible shear force holding power a. o. for a better grip in vertical applications

### Technical data TMC 300:

- Weight: Only 1 kg
- Tear-off force: 300 kg (at a 6 mm thick steel sheet S 235)
- Length: 82.5 mm, Width: 80 mm, Height: 32.5 mm

Prod.-No. 41100

## TMC 300 OPTIONS

**THE TMC 300 (PROD.-NO. 41100) IS AVAILABLE IN A VARIETY OF CONFIGURATIONS AND PERFECTLY DESIGNED FOR GETTING MODIFIED BY YOU.**

## TMH 50 – HAND LIFTING MAGNET



### Key facts TMH 50 – Hand Lifting Magnet:

- Max. lifting capacity: 50 kg – (even from 3 mm sheet metal S235)
- Protects hands and fingers from hot and sharp steel
- Invaluable for anyone f. e. moving parts from one place to another (max. temperature: 80°)

### Technical data TMH 50 – Hand Lifting Magnet:

- Weight: 1.6 kg
- Max. lifting capacity at vertical lifting: 50 kg
- Length: 126 mm, Width: 80 mm, Height: 100 mm;  
with handle: Length: 190 mm, Width: 124 mm

Prod.-No. 41100.H

## TML 100 – LIFTING MAGNET



### Key facts TML 100 – Lifting Magnet:

- Max. lifting capacity of 50 kg at 3 mm material thickness and 100 kg lifting capacity from 6 mm (at safety factor 1:3)
- Outstanding performance on thin walled materials (already applicable from 1 mm material thickness)
- 360° rotating and swiveling hook (also at maximum load)

### Technical data TML 100 – Lifting Magnet:

- Weight: 1.7 kg
- Tear-off force: 300 kg (from 6 mm sheet metal S235)
- Max. lifting capacity at vertical lifting: 30 kg at 90°
- Length: 82.5 mm, Width: 80 mm, Height: 85 mm (lifting hook folded down) 147 mm (lifting hook folded up)

Prod.-No. 41100.L



**ONE SOLUTION FOR HUNDREDS OF APPLICATION POSSIBILITIES!**

**LIFTING-MOVING-POSITIONING-ALIGNING-FORMING-TRANSPORTING**



## SET TMA 300 – VARIABLE WELDING ANGLE



### Key facts Set TMA 300 – Variable Welding Angle:

- Stepless adjustable angle side plates from 0° to 90° to hold/weld worksheets
- Invaluable for anyone, who has to weld together heavy worksheets in different angles
- Light-weighted, easy and trouble-free handling

### Technical data Set TMA 300:

- Tear-off force: 300 kg (at 6 mm steel sheets S235)
- Weight: 2.7 kg
- Length: 162 mm, Width: 124 mm, Height: 223 mm

Prod.-No. 41100.A

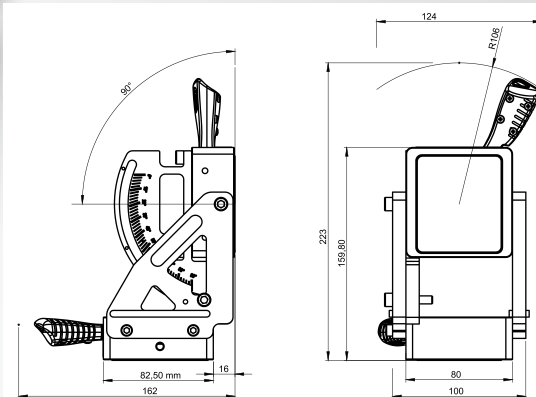
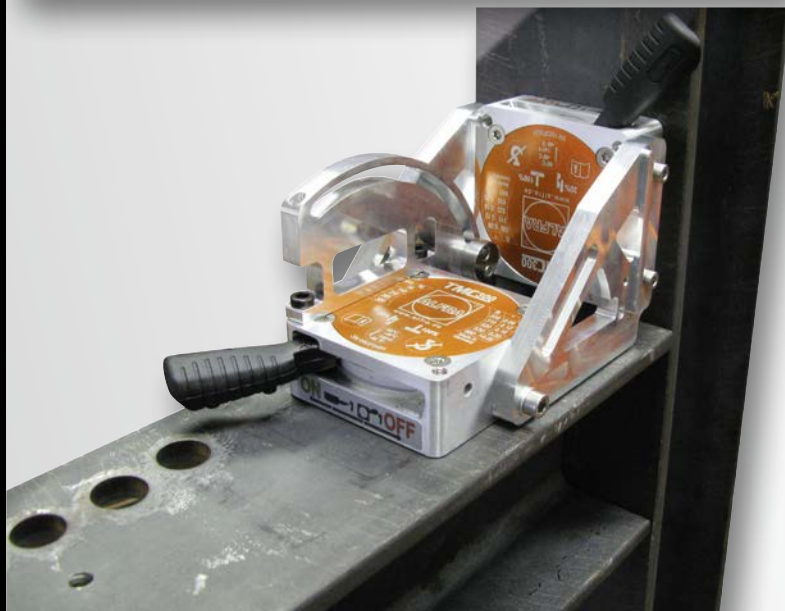

## ALFRA – MAGNET CHIP REMOVER



### Key facts Magnet Chip Remover:

- A magnet is moved up and down in a stainless steel round stick. The strong magnet pulls the metal chips to the stick – pull the button and the chips will fall off.
- More cleanliness at the working desk
- ALFRA Magnet Chip Remover Length: 400 mm

Prod.-No. 18654

Subject to our general sales conditions



ALFRA Alfred Raith GmbH • 2. Industriestrasse 10 • DE-68766 Hockenheim • Tel.: +49 (0) 62 05/30 51-0  
Fax.: +49 (0) 62 05/30 51-135 • Internet: [www.alfra.de](http://www.alfra.de) • E-mail: [export@alfra.de](mailto:export@alfra.de)

